



THE CONNECTICUT LIGHT AND POWER COMPANY

A NORTHEAST UTILITIES COMPANY

JOHN J. SMITH
District Manager

February 22, 1974

Mr. Fred Orrico
King Neptune Restaurant
665 Danbury Road
Ridgefield, Connecticut
06877

Re: Electrical Service Costs - D'I'hy Ridge Golf Course

Dear Fred:

The costs to provide electrical service to the Municipal Golf Course will remain the same as we determined in November of last year.

The enclosed sketch shows the anticipated route to provide power to the clubhouse, the storage barn, and the water pumps. The total cost to you would be \$5,728.00 for the cable and its installation. The cost for service to the clubhouse alone would be \$2,070.00.

In addition, your contractor would be required to provide all trenching and backfilling, the secondary wiring, the concrete pads for the transformers, and any conduit necessary at the pads and along the service route.

We would appreciate having a breakdown of all electrical loads as soon as possible so we are able to order necessary materials. If I can provide any assistance or information, please contact me at any time.

Sincerely,

Douglas R. Cahill,
Senior Energy Counsellor
Energy Consulting Services Department

DRC/pmd



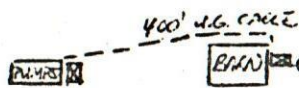

THE ROLLING HILLS
COUNTRY CLUB HAS AN
ELECTRICALLY HEATED
STORAGE + CHARGING AREA
FOR THEIR CARTS.

PEAK DEMAND \approx 60KW

A 400 AMP 3 ϕ MAIN SWITCH
IS MORE THAN ADEQUATE FOR
SUCH A LOAD

DL'HY RIDGE GOLF COURSE

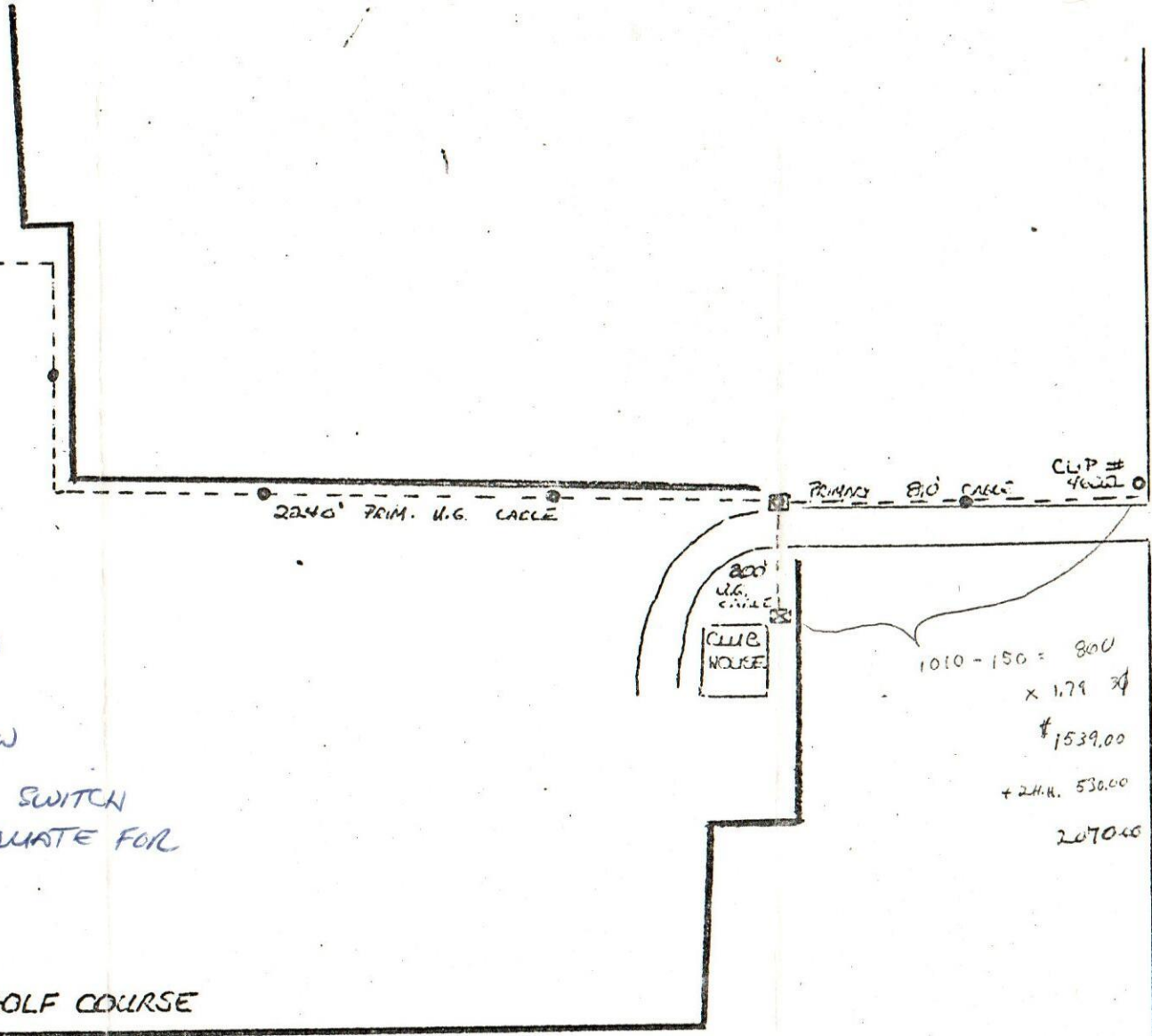

1010 - 150 = 860
x 1.79 ϕ
\$1539.00
+ 2 H.H. 530.00
2070.00

KEY

- 15KV PRIMARY CABLE
- ⊗ TRANSFORMER LOCATION
- HANDHOLE OR SPICEBOX
- PROPERTY LINE